

## BALLROOM LEVEL FLOOR PLAN

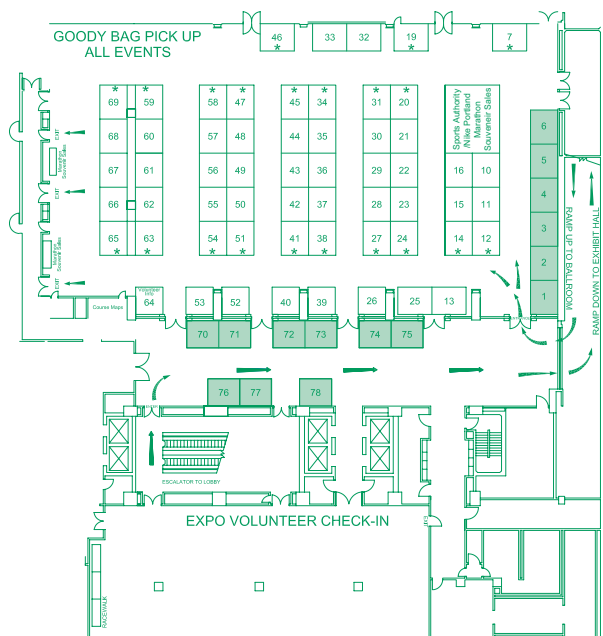

• Shaded booths are reserved for sponsors

Please note: Floor plans are subject to change

## EXHIBIT HALL FLOOR PLAN

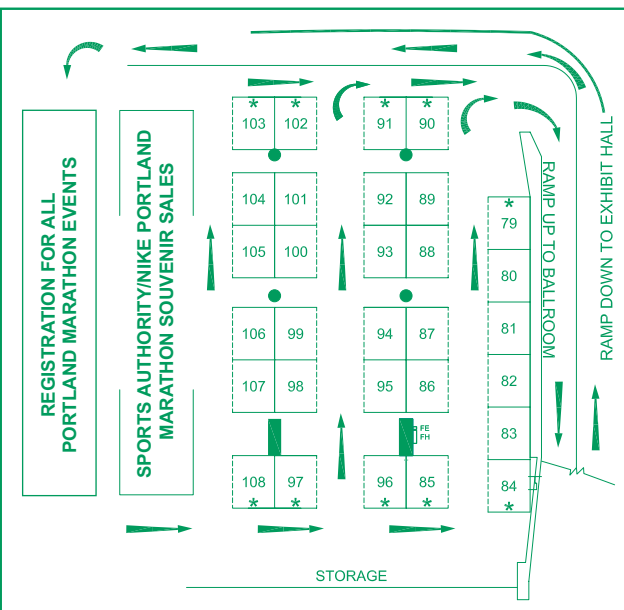

• back walls, side walls, or other standing equipment may not exceed 7 ft. in Exhibit Hall booths

## 2008 Portland Marathon Sports Authority Expo Exhibitors

Erin Baker's Wholesome Baked Goods  
FlashPRO Event Photography  
Gleukos Performance Beverage  
Glory Bee Foods  
Kaiser Permanente  
Nestle  
Nike  
Rodale Tylenol  
Sports Authority  
Subaru  
The Portland Hilton  
Ultima Replenisher  
Unified Grocers

Absolute Life Chiropractic  
adidas America  
AdvoCare  
All Tri Sports  
American Cancer Society  
American Laser Centers  
American Volkswalk  
Arthritis Foundation  
Asics Tiger Corporation  
Association of International Marathons  
Big Sur International Marathon  
BondiBand  
Brooks  
California International Marathon  
Children's Tumor Foundation  
Competitor Magazine NW  
Disney Sports Attractions  
Elite Racing, Inc.  
Fila  
Fit Right Northwest  
Foot Traffic  
Garmin  
GasCap  
Ionways  
Kris & Katy Design  
Leukemia & Lymphoma Society/Team in Training  
Marathon Charms & Gifts  
Marathon Clinic/Team Oregon  
Merrell  
Mizuno  
MonTees

Mountain Shop  
New Balance  
Nuun Active Hydration  
Oiselle Running  
Oregon Road Runners Club  
Pace Setter Athletic  
Pearl Izumi  
Polar Heart Rate Monitors  
Portland Running Company  
Pefontaine Productions, LLC  
Pro-Tec Athletics  
Puma  
PureFit Inc.  
Saucony  
SMART  
Smartwool  
SPiBelt  
Spokane to Sandpoint Team Relay  
SportsLife Media, Inc.  
Sugoi  
Superfeet  
The Stick-RPI of Atlanta  
Therapeutic Associates, Inc.  
Tiger Tail Rolling Muscle Massager  
26.2 w/ Donna,  
The National Marathon to Fight Breast Cancer  
Univera Life Sciences  
Wahine Sport  
Wonders of Walking  
Wrightsock

2009

SPORTS AUTHORITY®

Sports AND Fitness EXPO

SPORTS AUTHORITY®

Sports AND Fitness EXPO

PORTLAND MARATHON

In Association With



Friday, Oct. 2, 11 a.m.-8 p.m.  
Saturday, Oct. 3, 9 a.m.-7 p.m.

Portland Hilton Hotel  
921 S.W. 6th Avenue, Portland, Oregon  
Ballroom Level & Exhibit Hall

PORTLAND MARATHON

# SPORTS AUTHORITY®



**A proven success**, the Portland Marathon Sports Authority Sports and Fitness Expo is your opportunity to promote and sell to a targeted audience of dedicated runners and fitness enthusiasts from throughout the United States, Canada, Mexico, Europe, and Japan.

**Maintain maximum exposure** for two days as Marathon weekend entrants of all ages attend the Expo to buy your product or use your service, and complete required registration for their respective run or walk event.

**Advance promotion**, including radio spots, local television and newspaper stories, coverage in Oregon Road Runners Club publications, and Marathon weekend entry booklets assures outstanding attendance at this event which draws over 14,000 people each year. Admission is free to the public.

**Fun and informative**, the Expo focuses on health screening checks and demonstrations; sports medicine and fitness programs; innovative fitness clothing, shoes, and training aids; and other run and walk related products and services. Everyone can attend free lectures by local and national sports medicine specialists, and noted personalities and columnists in the running and walking community.

**Register early** for your preferred booth space!

## BALLROOM LEVEL

**Booth Rental:** 8' deep x 10' wide

### Profit organization ---

\$1000.00 per booth

\* \$1100.00 per corner booth (see map for \*)

### Non-profit organization ---

\$850.00 per booth

\* \$1100.00 per corner booth (see map for \*)

## EXHIBIT HALL

**Booth Rental:** 8' deep x 10' wide

### Profit organization ---

\$700.00 per booth

\* \$775.00 per corner booth (see map for \*)

### Non-profit organization ---

\$550.00 per booth

\* \$775.00 per corner booth (see map for \*)

**Space Assignment:** first-come, first-reserve basis.  
Refer to Expo map when selecting your preferred booth space.

### Booth Rental Includes:

8' high backdrop (Ballroom level)/7' high backdrop (Exhibit Hall), 3' high side skirts, 7" x 40" booth identification sign, one 6' skirted table, carpeting and 24-hour security.

**Show Decorator:** Confirmed exhibitors will receive order forms for special services, such as signs or banners, chairs, electrical needs, drayage, labor, etc. from show decorator.

### Booth Payment:

Return registration form with a non-refundable, 50% deposit of total booth cost. Booth confirmation contracts and set-up instructions sent upon receipt of deposit. Balance due on or before August 14, 2009.

### Booth Cancellation:

Cancellation of booth space after August 21, 2009 forfeits total booth payment.

**MOVE-IN:** Thursday, Oct. 1, 6 p.m. - 8 p.m.  
Friday, Oct. 2, 8 a.m.-11 a.m.

**MOVE-OUT:** Saturday, Oct. 3, 7 p.m.-8 p.m.

## 2009 PORTLAND MARATHON EXPO REGISTRATION

\_\_\_\_\_ **FIRM NAME** for Billing \_\_\_\_\_ **CONTACT** Person for Expo

\_\_\_\_\_ Mailing Address to receive **Expo Confirmation Materials**

\_\_\_\_\_ City \_\_\_\_\_ State \_\_\_\_\_ Zip \_\_\_\_\_

\_\_\_\_\_ **MAILING ADDRESS FOR BILLING PURPOSES** - *if different from above mailing address*

( ) ( ) \_\_\_\_\_ **CONTACT** Telephone / Fax \_\_\_\_\_ Email Address (*\*required for exhibit space registration*)

\_\_\_\_\_ **Name for BOOTH SIGN** \_\_\_\_\_ *If different, Name for FLOOR PLAN*

\_\_\_\_\_ Briefly describe the product or service you will be promoting at the Expo.

Will you be selling?  Yes  No

Will you be giving away product?  Yes  No

Please reserve 1 2 3 4 or more booths (indicate number needed). List below your preferences for booth space. Refer to floor plan for location numbers.

1 \_\_\_\_\_ 3 \_\_\_\_\_  
2 \_\_\_\_\_ 4 \_\_\_\_\_

**Make check payable to: Portland Marathon Sports and Fitness Expo**

Send completed form and deposit to:

**Debbie Frank**  
**Portland Marathon Sports and Fitness Expo**  
P.O. Box 19478, Portland, OR 97280

Phone: 503-636-1725  
Fax: 503-636-1753  
Email: debbie@trio-realty.com