

BALLROOM LEVEL FLOOR PLAN

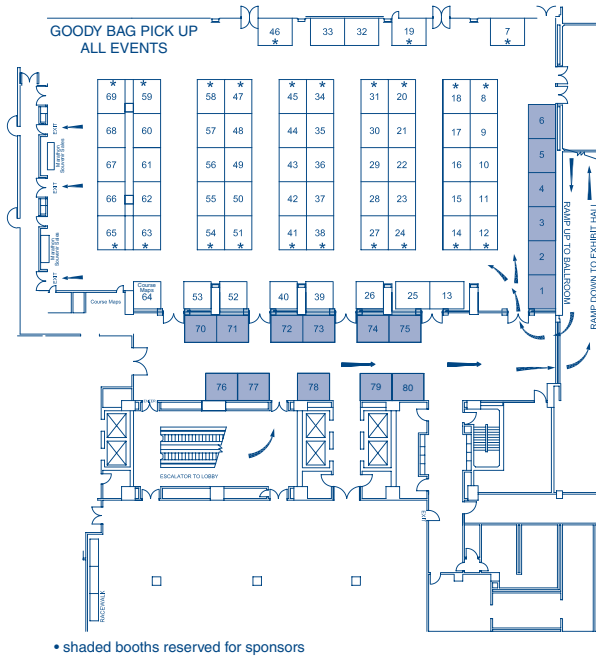

* shaded booths reserved for sponsors

Please note: Floor plans are subject to change

EXHIBIT HALL FLOOR PLAN

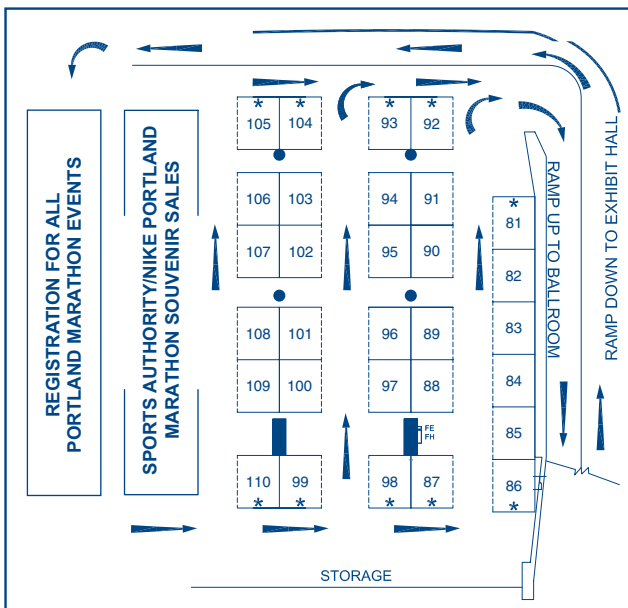

* back walls, side walls, or other standing equipment may not exceed 7 ft in Exhibit Hall booths

2009 Portland Marathon Sports Authority Expo Exhibitors

Broadway Toyota
FlashPRO Event Photography
Gleukos Performance Beverage
Kaiser Permanente
Nestle
Nike
Sports Authority
The Portland Hilton
Ultima Replenisher

adidas America
AIMS
American Cancer Society
American Volkswalk
Amica Seattle Marathon
Anthony D. Body Running Art
Arthritis Foundation
Asics Tiger Corporation
Banana Blossom Press
Be the Match
Big Sur International Marathon
Brooks
California International Marathon
Cascadian Farm
Children's Tumor Foundation
Elite Racing
Eugene Marathon
Fit for Sports
Fit Right Northwest
Foot Traffic
Kathy Loper Events
KT Tape
Larabar
Leukemia & Lymphoma Society/Team in Training
Manzella
Marathon Charms & Gifts
Marathon Clinic/Team Oregon
Marathon Jewelry
Merrell
Mizuno

National Running Center
New Balance
Oiselle Running
One More Mile
Oregon Road Runners Club
Pace Setter Athletic
Pearl Izumi
Polar Electro
Portland Running Company
Power Balance, Inc
Prague Marathon
Precision Sport Eyewear
Pro-Tec Athletics
Puma
PureFit Nutrition Bars
Ray of Hope Foundation
Road Runner Sports
San Francisco Marathon
Saucony
Smartwool
SPIbelt
Superfeet
The Natural Athlete
The Stick-RPI of Atlanta
Therapeutic Associates, Inc.
Thorlo
Tiger Tail
U.S. Navy
USA-Sport
Wrightsock
Yurbuds Earbud Enhancers

2010

SPORTS AUTHORITY®

2010 
Sports AND Fitness EXPO

Friday, Oct. 8, 11 a.m. - 8 p.m.
Saturday, Oct. 9, 9 a.m.- 7p.m.

Portland Hilton Hotel
921 S.W. 6th Avenue, Portland, Oregon
Ballroom Level & Exhibit Hall

SPORTS AUTHORITY®

2010 
Sports AND Fitness EXPO

PORTLAND MARATHON

In Association With



PORTLAND MARATHON

SPORTS AUTHORITY®



A proven success, the Portland Marathon Sports and Fitness Expo is your opportunity to promote and sell to a targeted audience of dedicated runners and fitness enthusiasts from throughout the United States, Canada, Mexico, Europe, and Japan.

Maintain maximum exposure for two days as Marathon weekend entrants of all ages attend the Expo to buy your product or use your service, and complete required registration for their respective run or walk event.

Advance promotion, including radio spots, local television and newspaper stories, coverage in Oregon Road Runners Club publications, and Marathon weekend entry booklets assures outstanding attendance at this event which draws over 14,000 people each year. Admission is free to the public.

Fun and informative, the Expo focuses on health screening checks and demonstrations; sports medicine and fitness programs; innovative fitness clothing, shoes, and training aids; and other run and walk related products and services. Everyone can attend free lectures by local and national sports medicine specialists, and noted personalities and columnists in the running and walking community.

Register early for your preferred booth space!

BALLROOM LEVEL

Booth Rental: 8' deep x 10' wide

Profit organization ---

\$1100.00 per booth

* \$1400.00 per corner booth (see map for *)

Non-profit organization ---

\$850.00 per booth

* \$1400.00 per corner booth (see map for *)

EXHIBIT HALL

Booth Rental: 8' deep x 10' wide

Profit organization ---

\$800.00 per booth

* \$900.00 per corner booth (see map for *)

Non-profit organization ---

\$550.00 per booth

* \$900.00 per corner booth (see map for *)

Space Assignment: first-come, first-reserve basis.

Refer to Expo map when selecting your preferred booth space.

Booth Rental Includes:

8' high backdrop (Ballroom level)/7' high backdrop (Exhibit Hall), 3' high side skirts, 7" x 40" booth identification sign, one 6' skirted table, carpeting and 24 hour security.

Show Decorator: Confirmed exhibitors will receive order forms for special services, such as signs or banners, chairs, electrical needs, drayage, labor, etc. from show decorator.

Booth Payment:

Return registration form with full payment. Booth confirmation contracts and set-up instructions sent upon receipt of payment. No credit cards accepted.

Booth Cancellation:

Cancellation of booth space after August 27, 2010 forfeits total booth payment.

MOVE-IN: Thursday, Oct. 7, 6 p.m. - 8 p.m.

Friday, Oct. 8, 8 a.m.-10:30 a.m.

MOVE-OUT: Saturday, Oct. 9, 7 p.m.-8 p.m.

2010 PORTLAND MARATHON EXPO REGISTRATION

FIRM NAME for Billing _____

CONTACT Person for Expo _____

Mailing Address to receive Expo Confirmation Materials _____

City _____

State _____

Zip _____

MAILING ADDRESS FOR BILLING PURPOSES - *if different from above mailing address*

() ()

CONTACT Telephone/Fax _____ Email Address (*required for exhibit space registration)

Name for BOOTH SIGN _____

If different, Name for FLOOR PLAN

Briefly describe the product or service you will be promoting at the Expo.

Will you be selling? Yes No

Will you be giving away product? Yes No

Please reserve 1 2 3 4 or more booths (indicate number needed). List below your preferences for booth space. Refer to floor plan for location numbers.

1 _____ 3 _____

2 _____ 4 _____

Make check payable to: Portland Marathon Sports and Fitness Expo

Send completed form and full payment to:

Debbie Frank
Portland Marathon Sports and Fitness Expo
P.O. Box 19478, Portland, OR 97280

Phone: 503-636-1725

Fax: 503-636-1753

Email: debbie@trio-realty.com